



ALPIN CHALET X-LARGE - WAGRAIN



ALPIN-CHALET.COM



FOR MOUNTAIN FANS

Rent an alpine dream chalet

for solo occupancy, completely for yourselves, your friends and your family. With the charm and cosiness of a mountain lodge, but with the comfort of a large, modern, holiday home.

ALPIN CHALET –

a innovative concept for a holiday home.

Chalets for **sole use**, for groups of 8, 12, 18, 24 or 30 people. Available as self-catered Chalet for hobby chefs, or with breakfast, halfboard or fully catered – Private hotel ALPIN CHALET.



The ALPIN CHALET is a cut above the rest

Location and atmosphere raise the chalet to higher spheres. You are majestically seated above everyday life. Far away from the mainstream and out of the ordinary. The thrill of the ultimate change of scenery is guaranteed.

Cosy nests to snuggle up in at night, an ALPIN ATRIUM for those who like to play, grown-ups and kids alike, a private sauna with a view, a kitchen like in a restaurant for passionate hobby chefs, an ALPIN LOFT as a high seat amidst the nature of the impressive mountains.

The architecture of the ALPIN CHALET

The most beautiful elements of a cosy lodge combined with the open elements of a modern loft:

- open rooms and plenty of windows with scenic views
- traditional handicraft – aesthetic in design yet with straightforward functionality
- down-to-earth, natural materials – ecologically conscious
- timber floor boards and stone floors with floor heating
- central heating with a renewable energy
- open and visible carpentry of the roof construction, larch wood furniture.



ALPIN CHALET XL IN WAGRAIN

XL FOR XL FAMILIES

A full floor, an entire open attic with high alpine wooden rafters: This is the ALPIN LOFT in the ALPIN CHALET XL. Open plan with kitchen, long bar, fireplace oven, panoramic views, wide corner benches and XL tables as a living and eating area, with large terrace and Rattan furniture, large Teak dining tables, BBQ with charcoal grill.

On the sleeping level, 9 variable sleeping nests

A cozy double bed, a two bed room with two reading lights one above the other, it can be a room for 3 or even 4 people if required. However the group wants to arrange itself. 5 sleeping nests with shower/WC and 2 family rooms with lobby, 2 sleeping nests and shower/WC. Each of the 9 bed rooms in the ground floor has 4 sleeping places.

The central area - the ALPIN ATRIUM with huge couch area, flat-TV, Playstation and Info boards.

In every chalet there is a sauna, the XL chalets also have a bathtub. For a tidy house a lobby room with cloakroom benches and pegs for shoes and jackets, a wall with boot driers, and of course a washing machine and tumble dryer and a well equipped broom cupboard for all the willing house husbands.



SLEEPING LEVEL CHALET XL

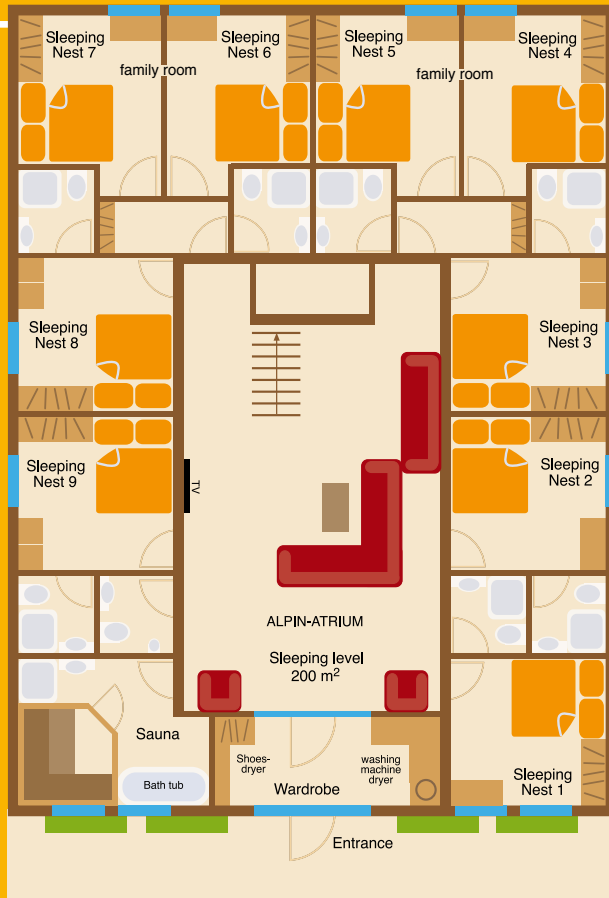

LIVING ROOM LEVEL CHALET XL

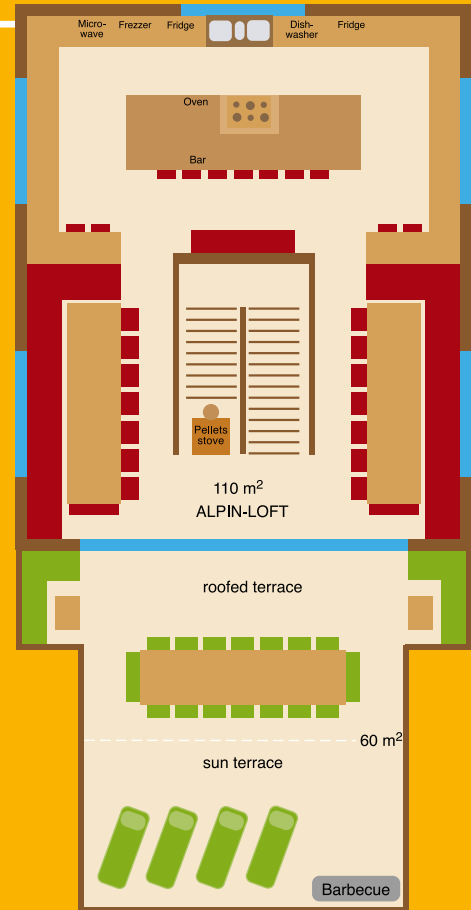



ALPIN LOFT DINNING AREA



XL-KITCHEN FOR HOBBY CHEFS



ALPIN ATRIUM WITH TV & PLAYSTATION



9 SLEEPING NESTS



All pictures on this page - ALPIN CHALET XL

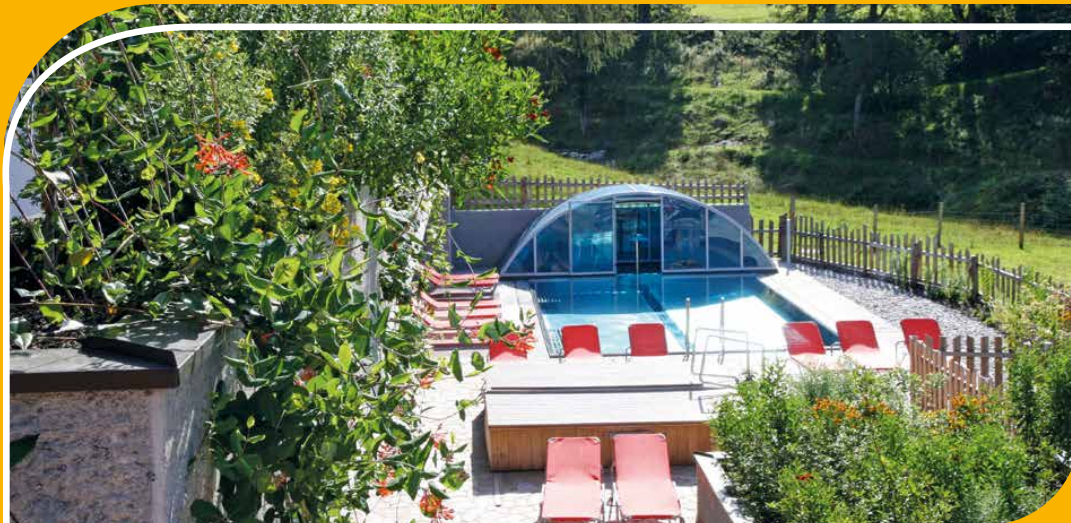

POOL WITH WATERFALL AND WHIRLPOOL BENCH IN SUMMER



WHIRLPOOL IN WINTER



TERRACE WITH BARBECUE AREA

ALPIN-CHALETs XL IN WAGRAIN

Wagrain • 4 ALPIN CHALETs XL & 4 extra rooms

• Address: 5602 Wagrain, Weberlandl 19

ALPIN CHALETs XL on the sunny slopes of Weberlandl. Nicked named Weberly Hills. Free and open to the south west, with views of the Family Hiking and Ski area Grafenberg and the Grießenkar – the ski and bike mountain connected with Flachau. Ski in, ski out to the Widmoospiste, nearest lift station – The Flying Mozart Gondola, Après ski, cross country trails. The chalets have an outdoor area: In Winter a large whirlpool, in Summer a heated swimmingpool.







ALL ALPIN
CHALETs
IN SKI AMADÉ
IN THE
SALZBURG
REGION



SALZBURG - WIEN - MÜNCHEN
70 km 320 km 200 km



BISCHOFFSHOFEN

A10

FILZMOOS

- 2 ALPIN CHALETs Classic
- 1 ALPIN CHALET Large & 2 Extrazimmer
- 1 Indoor Pool (Sommer & Winter)



FILZMOOS

EBEN

FLACHAU

- 2 ALPIN CHALETs Classic & 5 Extrazimmer

RADSTADT

ST. JOHANN/
PONGAU

WAGRAIN

- 4 ALPIN CHALETs XL & 4 Extrazimmer
- 1 Outdoor Pool (Sommer)
- 1 Whirlpool (Winter)

SCHLADMING
30 km

ALTENMARKT

FLACHAU

A10

WAGRAIN

KLEINARL

- 3 ALPIN CHALETs Large & 3 Extrazimmer
- 1 Outdoor Pool (Sommer)

KLEINARL



FLACHAUWINKL

ZAUCHENSEE



VILLACH - VENEDIG
110 km 360 km



FLACHAUWINKL

- 4 ALPIN CHALETs Classic & 5 Extrazimmer
- 1 Outdoor Pool (Sommer)

SEE YOU AT ALPIN CHALET





ALPIN CHALET GMBH

RESERVATION OFFICE

Höhweg 152 * A-5542 Flachau

Tel +43 6457 307912

info@alpin-chalet.com

www.alpin-chalet.com

The 5 edelweiss of the ALPIN CHALETs stand for:

- * Architecture, interior equipment & ambiance
- * Hosting, hospitality & private services
- * Storage, garden area & mountain panorama
- * Tidiness & always spotlessly clean
- * Renewable energy & ecology



ALPIN-CHALET.COM